



PRESS RELEASE 1-2014

Dural USA at the Surfaces trade fair 2014 in Las Vergas – Booth B, 4438 Level 1 Bayside

**No barriers, shower in comfort:
Complete waterproof systems for floor-level tiled showers**

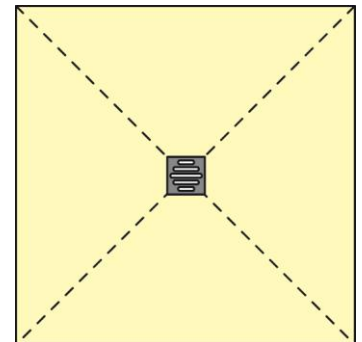
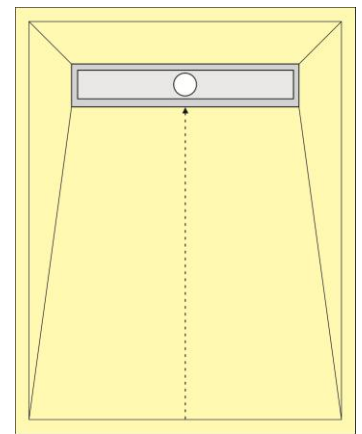
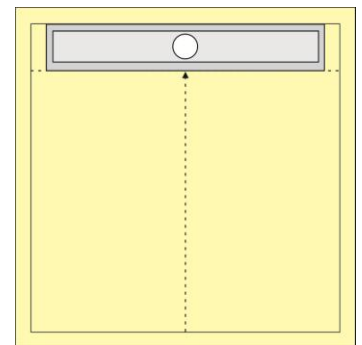

Photo: "TILUX-LINE board with linear drain" from Dural

DURAL USA, 1080-A Duncan Avenue – Chattanooga, TN 37404
Telephone: +1 (423) 531-7590, scottcarroll@duralusa.us

Press contact - DURAL GmbH & Co. KG, Marketing Manager Stefanie Görtz, Südring 11, D-56412 Ruppach-Goldhausen
Telephone: +49 (0) 2602 9261 629, s.goertz@dural.de

Printing free of charge

please forward a copy

Floor-level showers are sought after. Dural offers an entire range of system solutions to make installation as easy and safe as possible. From complete shower base units to linear drainage systems. At this year's SURFACES trade fair in Las Vegas, Dural will also be presenting its new "TILUX-LINE" shower board with linear drain, which offers maximum safety in terms of waterproofing and installation and particularly flexible design possibilities using the VARIO-LINE drain system accessories.

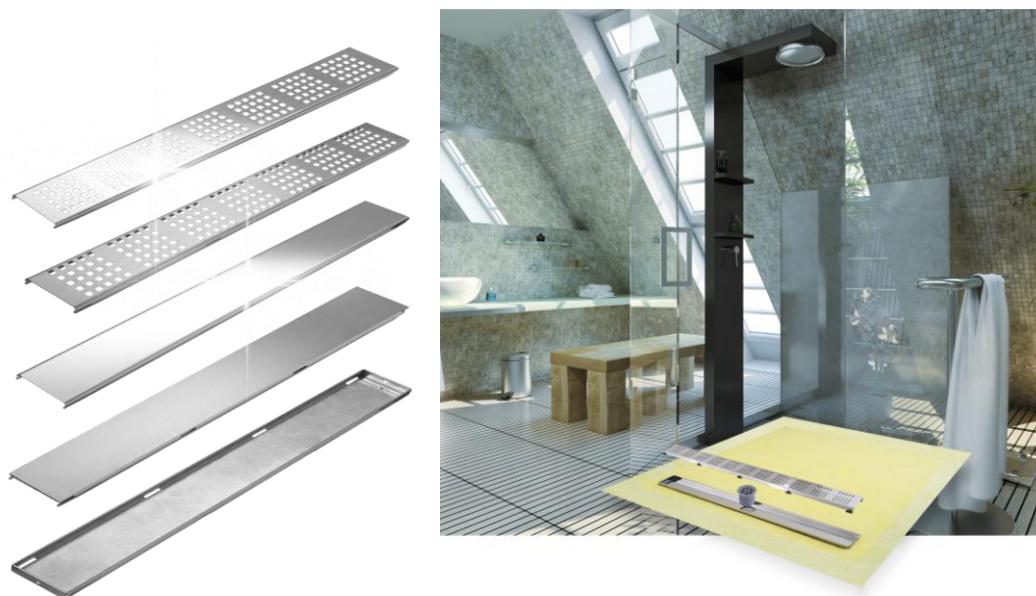

Photos: "Design grates for TILUX-LINE and VARIO-LINE" / "TILUX-LINE shower board" from Dural

This complete package with outlet and sealing – both are integrated – is available in various square and rectangular sizes with 1-directional gradient ideal for large size tiles and 4-directional gradient. Sizes range for example from 90 x 90 cm, 120 x 90 up to 150 x 150 cm with point drain suitable for wheelchair access showers.

Unique and absolutely safe is the **integrated deep-drawn sealing foil** which securely waterproofs the top for straight tiling . A **counteracting waterproofing foil** is fixed at the rear side of the board to avoid bending.

DURAL USA, 1080-A Duncan Avenue – Chattanooga, TN 37404
Telephone: +1 (423) 531-7590, scottcarroll@duralusa.us

Press contact - DURAL GmbH & Co. KG, Marketing Manager Stefanie Görtz, Südring 11, D-56412 Ruppach-Goldhausen
Telephone: +49 (0) 2602 9261 629, s.goertz@dural.de

Printing free of charge

please forward a copy

Perfect gradient



For a perfect finish of a 1-directional 2% gradient there is the stainless steel gradient profile available – also for the wall connection.

System advantages

Full variability – 9 drain channel lengths, 4 designer grilles and a tile frame. You have the choice.

Unique sealing system – absolutely tight and absolutely secure thanks to the continuous, deep-drawn sealant membrane.

Full height flexibility (for floor covering thicknesses of 6 to 21 mm) subsequent to the installation procedure itself.

With many other types of shower drainage channel, the frame height must be defined in advance.

Optimum hygiene due to the completely smooth and polished run-off surface of the stainless steel drain channel. Most of the currently available drainage channel systems have protruding fixings or undercuts that make cleaning difficult and cleaning intervals shorter. This is where most of the dirt and soap residues collect.

A second drainage level, to prevent water damage such as efflorescence and mould spots. Any water that seeps through the joints and under the tiling is drained away safely via the integrated seal in the drain. This prevents the kind of damage that often becomes visible only after a period of months or even years.

DURAL USA, 1080-A Duncan Avenue – Chattanooga, TN 37404
Telephone: +1 (423) 531-7590, scottcarroll@duralusa.us

Press contact - DURAL GmbH & Co. KG, Marketing Manager Stefanie Görtz, Südring 11, D-56412 Ruppach-Goldhausen
Telephone: +49 (0) 2602 9261 629, s.goertz@dural.de

Printing free of charge

please forward a copy

Easy, safe and waterproof installation straight to the wall with TILUX-LINE/VARIO-LINE

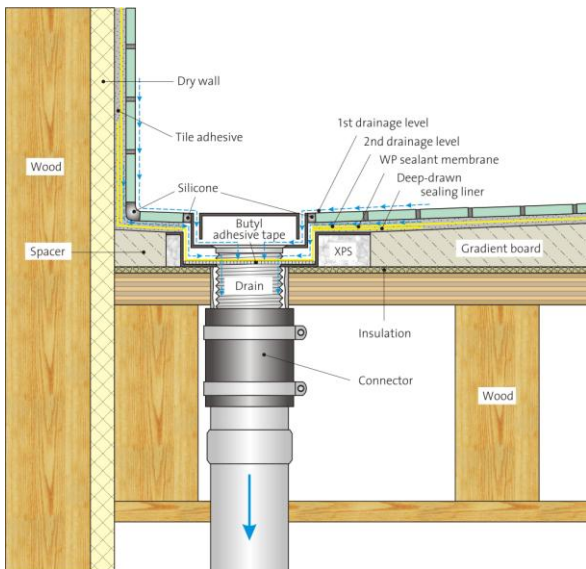
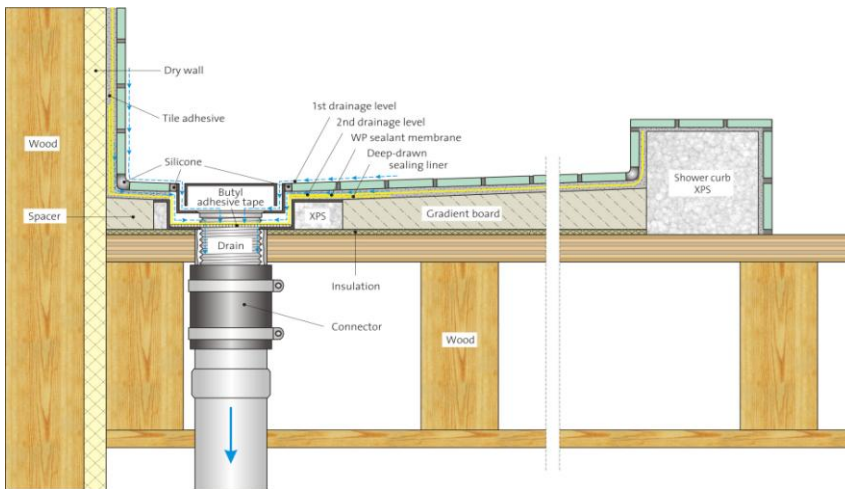

There is a **download-link** available for the hi-res photos (300dpi):

www.dural.de/ftp/Tilux-Line-Boards.zip

01-2014/sg

DURAL USA, 1080-A Duncan Avenue – Chattanooga, TN 37404
Telephone: +1 (423) 531-7590, scottcarroll@duralusa.us

Press contact - DURAL GmbH & Co. KG, Marketing Manager Stefanie Görtz, Südring 11, D-56412 Ruppach-Goldhausen
Telephone: +49 (0) 2602 9261 629, s.goertz@dural.de

Printing free of charge

please forward a copy